



Next-generation Intelligent Active Loudspeakers

L Class represents the next-generation of advanced, intelligent active loudspeakers for mobile and fixed entertainment applications.

Key Features

- Very high **SPL output** (138 dB peak) with impressive low frequency performance.
- Purpose-designed, **18-inch** (460 mm) long excursion direct radiating driver.
- Energy-efficient, 4000 W peak power **Class D** amplifier module with Power Factor Correction and extremely low AC consumption.
- Acoustic Linear Phase (**ALP**) design provides complementary coherence between QSC loudspeakers deployed in the same audio system delivering a uniform listening experience across the entire venue.
- **QSC SysNav™** (System Navigator) App allows the user to easily design, configure, control, monitor and apply signal processing to individual subwoofers, full arrays or groupings of both.
- Network solution includes digital audio-over-IP (**Dante®**) for interoperability with other audio equipment and seamless control and monitoring integration into the **Q-SYS Ecosystem** via Q-SYS Inventory Extensions.
- Omni-directional or **cardioid** radiation modes (cardioid setup requires min. 2 units).
- Selectable **DEEP™** mode for extremely low frequency extension.
- Rugged wooden enclosure with Polyurea coating for lasting **durability**.
- Four low-noise, heavy-duty **casters**.
- Vertical or horizontal **deployments** (M20 threaded pole receivers) combined with array frames and stack adapters or loudspeaker poles.
- Complemented by **LA108** and **LA112** active line array loudspeakers.
- Industry-best global **6-Year Extended Warranty** with product registration.



LS118 Active Subwoofer

Live Venues | Fixed Installations | Mobile Entertainers AV Rental/Event Productions

The LS118 is a next-generation, intelligent, active subwoofer featuring a brilliant combination of leading-edge innovation, refined engineering and unparalleled ease of use in an easy-to-deploy package.

Delivering extraordinary audio experiences and exceptional performance via system intelligence and premium components, the LS118 is the result of a deep understanding of customer needs and application requirements. The LS118 is easy to configure and deploy for applications ranging from simple, portable, plug-and-play setups, to demanding, networked, high-tech AV productions and fixed installations.

Featuring QSC Acoustic Linear Phase (ALP) design, which permits effortless combination and coherent deployment of QSC loudspeakers within the same sound system, the LS118 also provides daisy-chain connections for analog, networked digital audio (Dante®) and AC power (PowerCON TRUE1). Two or more LS118 can be configured in a cardioid arrangement, maximizing low frequency output in front while minimizing unwanted energy around the sides and rear of the system.

Together with the LA108 or LA112 active line array loudspeakers, the LS118 can be deployed with either an array frame/ground-stack adapter or using loudspeaker poles in both horizontal and vertical orientations.

The LS118 is backed by an industry-best global 6-Year Extended Warranty, with product registration.



LS118

Configuration	Direct radiating, active subwoofer
LF Transducer	460 mm (18-inch), cone
Frequency Response (-6 dB)	41 Hz - 98 Hz
Frequency Range (-10 dB)	35 Hz - 111 Hz
Nominal Coverage Angle	Omni-directional or cardioid radiation modes (cardioid setup requires min. 2 units)
Maximum Rated SPL ¹ (peak)	138 dB @ 1 m
Amplifier (peak)	Class D, 4000 W
Cooling	Low noise, variable speed fan
Controls	Rotary push encoder 2 x Push button (Menu, ID)
Display Screen	61 mm (2.4-inch) Full color display area (240 x 320 pixels)
Indicators	Power LED Limiter active LED Standby active LED 2 x Signal LED
Connectors	XLR Female (Analog In) XLR Male (Analog Thru) 2 x RJ45 EtherCON (Dante [®] and QSC SysNav [™] In/Thru) 2 x PowerCON TRUE1 (AC Power Inlet/Outlet)
AC Power Input	Universal power supply, 100-240 VAC, 50-60 Hz
AC Power Consumption ²	100 VAC, 3.6 A / 120 VAC, 3.0 A / 230 VAC, 1.7 A
Enclosure Material	15 mm birch plywood with Polyurea coating
Attachment Points	8 x M10 (for individual vertical or horizontal suspension/flying) 2 x M20 (for vertical or horizontal loudspeaker pole or ground-stack deployments)
Color	Black (RAL 9011)
Grille	16 GA Powder coated steel
Dimensions (H x W x D)	640 x 520 x 790 mm 25.2 x 20.5 x 31.1 inch
Net Weight	50 kg (110 lb) including casters
Shipping Weight	62.6 kg (138 lb)
Included Accessories	4 x Heavy-duty, low noise 4-inch casters, 1 x PowerCON TRUE1 power cable
Regulatory	UL, CE, FCC Class B

(1) Measured at 1 meter, on-axis, in half-space using Pink Noise, Crest Factor 10 dB unweighted.

(2) 1/8 power is representative of current draw with typical music program material with occasional clipping.
Dante is a registered trademark of Audinate Pty Ltd. EtherCON and PowerCON are registered trademarks of Neutrik.
Windows is a registered trademark of Microsoft. MacOS and iOS are registered trademarks of Apple.
Specifications subject to change without prior notice.



Measurements

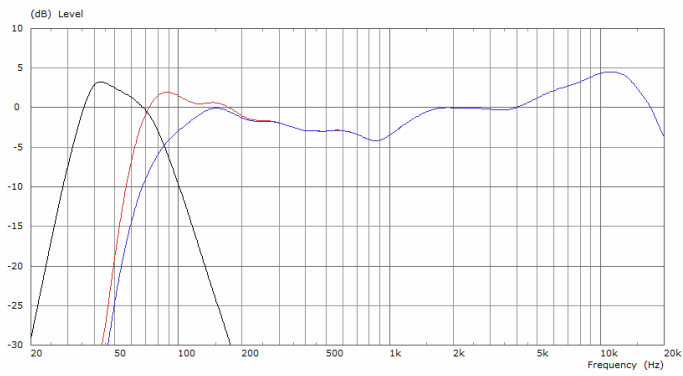

LS118 and LA108 frequency responses, on-axis at 1 m.

LA108 low-passed* (blue).

LA108 without subwoofer* (red).

(*) single-box voicing.

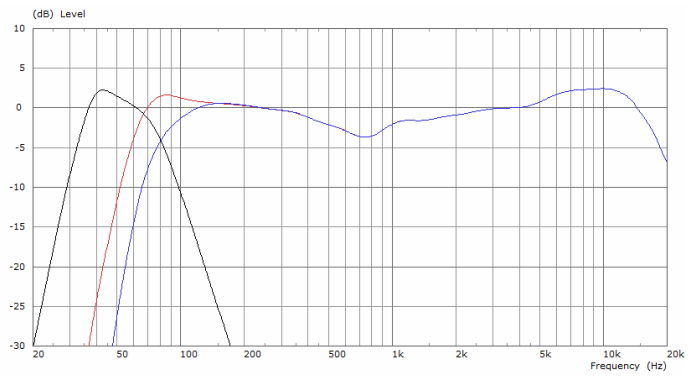

LS118 and LA112 frequency responses, on-axis at 1 m.

LA112 low-passed* (blue).

LA112 without subwoofer* (red).

(*) single-box voicing.

Floor Deployments

**Combined with LA108
Active Line Array Loudspeaker**



LA108 with QSC Array Frame (LA108-AF) and Stack Adapter (LA108-KIT-SA) accessories

LA108 with QSC SP-26 Loudspeaker Pole accessory (45 kg /100 lb safety rating)

**Combined with LA112
Active Line Array Loudspeaker**



LA112 with QSC Array Frame (LA112-AF) and Stack Adapter (LA112-KIT-SA) accessories

LA112 with QSC SP-26 Loudspeaker Pole accessory (45 kg /100 lb safety rating)

Dimensions

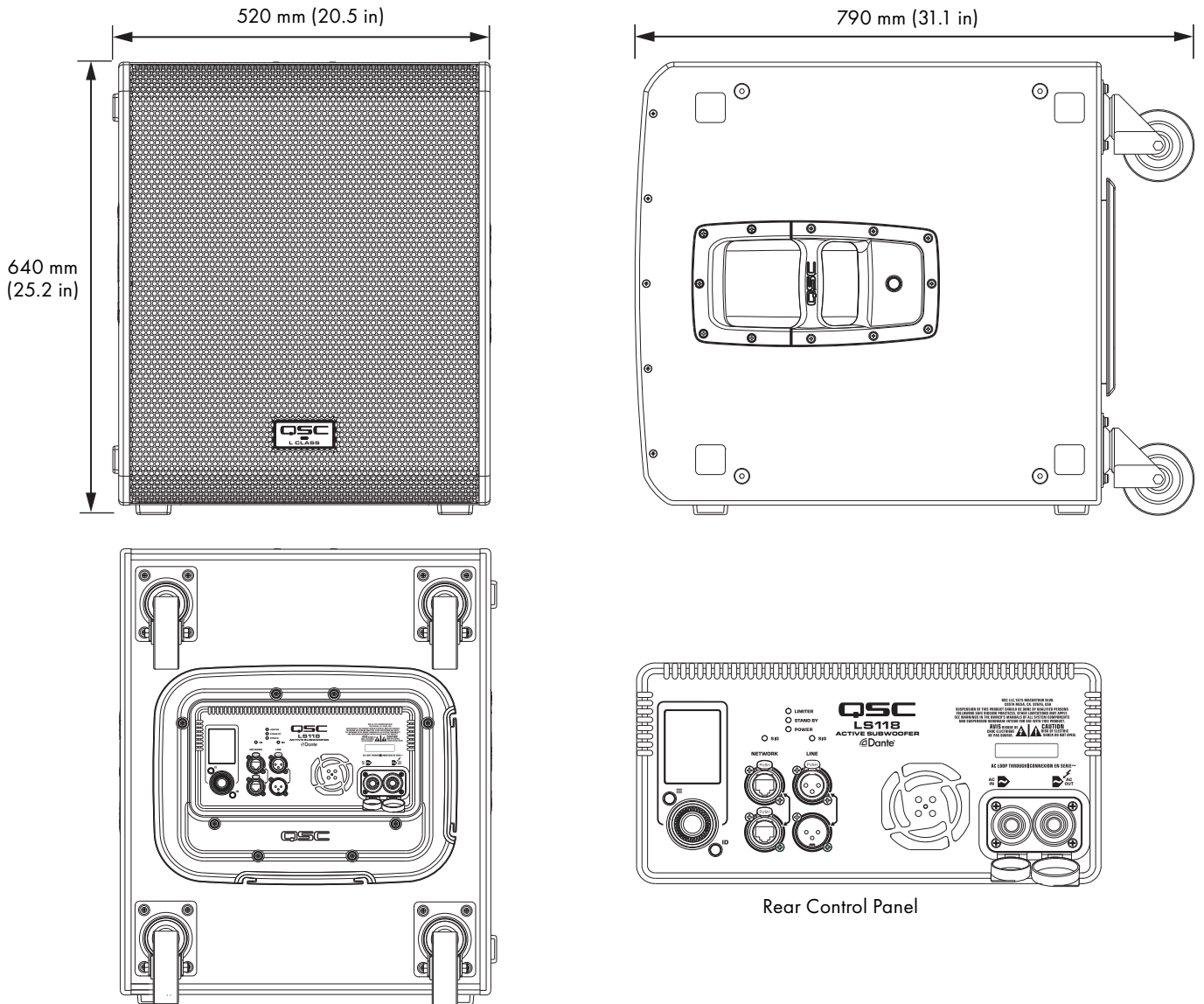

Optional Accessories

LS118

KS118-CVR	Soft Transport Cover made with heavy-duty Nylon/Cordura material, with grille guard
TWS-AMP	Universal Temporary Weather Shield protects the complete amplifier panel
LS-KIT-J	International Jumper Kit (2x 1.2 m PowerCON TRUE1 and 2x 1.2 m EtherCON jumpers, 1.5 mm ² /H05VV cables)
LS-KIT-J-NA	North America Jumper Kit (2x 48-in PowerCON TRUE1 and 2x 48-in EtherCON jumpers, 12 AWG/SVT cables, NEC compliant)
M10 Eyebolt Kit-S	Eyebolt kit for suspending subwoofers (4x M10×1.5, 35–38 mm eyebolts)

Mounting Accessories

Ground-Stack with LA108 loudspeaker:	LA108-AF (Array Frame) combined with LA108-KIT-SA (Stack Adapter Kit)
Ground-Stack with LA112 loudspeaker:	LA112-AF (Array Frame) combined with LA112-KIT-SA (Stack Adapter Kit)
Loudspeaker Pole SP-26:	66 cm/26-in long, with M20 thread
Loudspeaker Pole SP-36:	91 cm/36-in long, with M20 thread

qsc.com/contact-us

© 2024 QSC, LLC all rights reserved. QSC, Q-SYS and the QSC logo are registered trademarks of QSC, LLC in the U.S. Patent and Trademark office and other countries. All other trademarks are the property of their respective owners. Patents may apply or be pending.

QSC